



www.danumed.com/enswivel



Scan the QR Code
and watch the video
on the seamless
connection process
with the ENSwivel®

- ENFit® connectors minimize the risk of tubing misconnections and reduce the risk of harm for the patient

WHY ENFit®?

- Global patient safety initiative with new standard design for enteral connectors (ISO 80369-3)
- Incompatible with Luer connectors or other medical tubing systems

WHAT IS ENFit®?

ENSwivel® is a registered trademark of danumed Medizintechnik GmbH.

- danumed® Stopcock
 - danumed® GastroTubes
 - danumed® Extension Sets
 - danumed® Extension Sets for Gastrostomy Button
- Products with ENSwivel®:**

- Effortless connection by a "simple" Two-Finger-Turn™
- Secure and tight connection
- Twist-free – no twisting of tubes
- Simple, fast, comfortable

WHY ENSwivel®?

- Rotating ring mounted around the ENFit® connector
- Only the ENSwivel® ring is turned, not the entire system

WHAT IS ENSwivel®?



Global Trust in German Design & Quality



danumed
MEDIZINTECHNIK

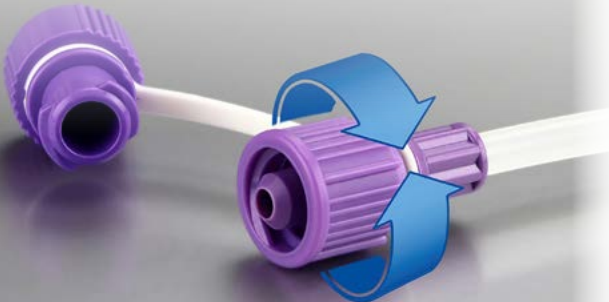

How to use
the innovative
ENSwivel®
for secure & easy
ENFit®
connections

How to connect the cap to the ENFit® connector with the ENSwivel® rotating ring



- Easy „TWO-FINGER-TURN“ for secure and tight connection

- ONLY turn the ENSwivel®
- Do NOT turn the cap
- STOP at resistance

- GAP = correct & tight
- NO GAP = too tight

With ENSwivel®

- HANDLING IS SIMPLE, FAST, COMFORTABLE

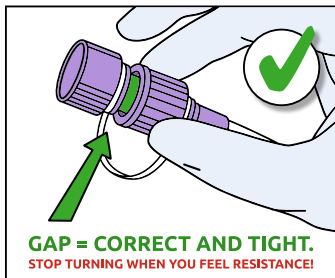
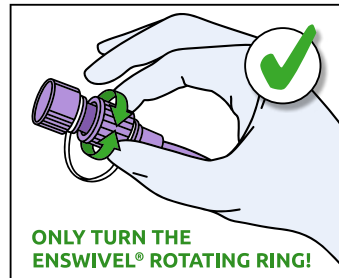
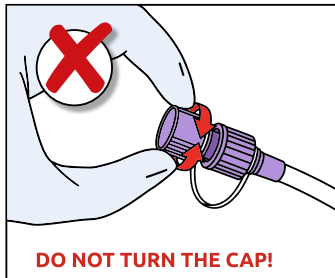

How to connect two ENFit® systems with the ENSwivel® rotating ring



- Easy „TWO-FINGER-TURN“ for secure and tight connection

- ONLY turn the ENSwivel®
- Do NOT turn the tubes
- STOP at resistance

- GAP = correct & tight
- NO GAP = too tight

With ENSwivel®

- TUBES ARE NOT TWISTED
- ENHANCED PATIENT & USER COMFORT

